

## Assembly Manual



### What's In The Box

Please inspect the contents of your shipped package to ensure you have received everything that is listed below.



**3 x Track Wheels**

---

All rights reserved.

No part of this document may be reproduced, stored in a retrieval system, or transmitted by any form or by any means, electronic, mechanical, photo-copying, recording, or otherwise, except as may be expressly permitted by the applicable copyright statutes or in writing by the Publisher.

## Track Wheel Setup

### Anchor Dolly Assembly

- Loosen the knobs of the Anchor Dolly.



- Stretch out its legs and open the Dolly.



- After opening the Dolly, re-tighten the knobs.



- Loosen the grub screw of the Anchor Dolly using the 4mm Allen Key (Not Included) to remove the Dolly wheel.
- Follow the same process to remove the remaining wheels.



### Track Wheel Assembly

- Insert the Track wheel into the Dolly's leg.
- Re-tighten the grub screw using the 4mm Allen Key.



- Follow the same process to attach the remaining track wheels.
- **Feature:** Equipped with sealed bearings, these track wheels boast a 360° swivel capability, providing precise and facilitating smooth navigation on straight and curved tracks.



## Track Wheel Mounting on Track

- Mount the Dolly on the Velvet steel track **(Not Included)** as shown in the images and your Anchor Dolly is ready to use.
- Feature:** The track wheel easily adapts to any 1 to 2" track system, including aluminum or PVC pipes.



## Track Wheel Attached to D-37

**NOTE:** To attach the track wheel to the D-33 & D-37 Dolly, use P-TWAD-337 adapter.

- Remove the wheel from the D-37 Dolly **(Not Included)** by rotating it.



- Loosen all bolts on the Adapter **(Not Included)** and slide it onto the Dolly's leg.

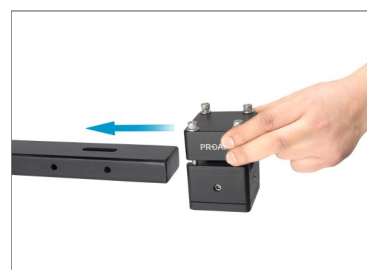

- Now, tighten all the bolts to secure the adapter.

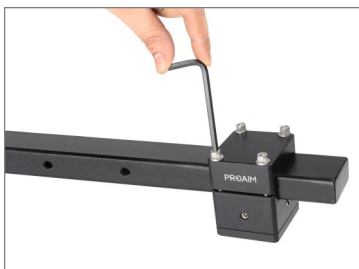

- Next, loosen all grub screws on the adapter.
- Then, attach the track wheel to the adapter.

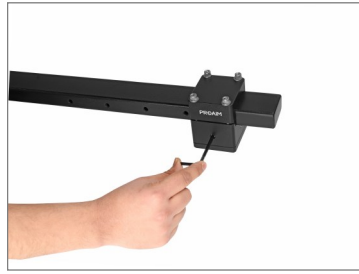

- Once the wheel is attached, tighten all grub screws.



- Finally, attach the tripod holder (Not Included) and mount the D-37 Dolly onto it.



## Compatible With D-33 & D-37 Dolly (Optional Adapter Set P-TWAD-337 Required)

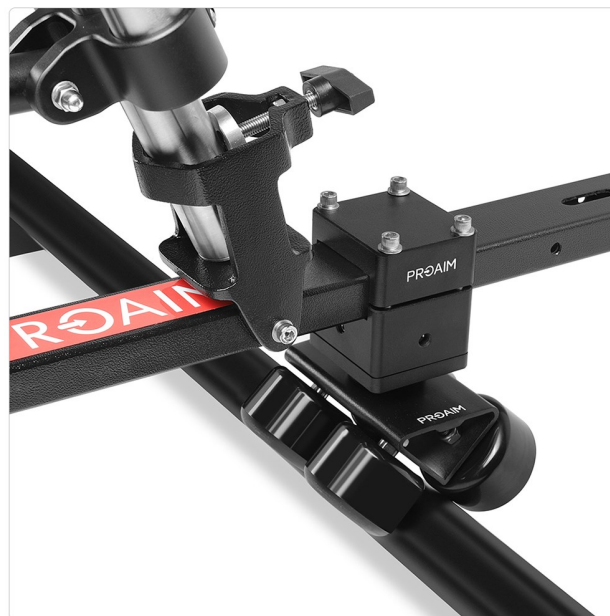

**YOUR PROAIM TRACK WHEEL SET FOR PROAIM ANCHOR DOLLY  
ALL DRESSED UP AND READY TO GO!**



**(SHOWN WITH OPTIONAL ACCESSORIES)**

**Warranty:** We offer one year warranty for our products from date of purchase. Within this period of time, we will repair it without charge for labor or parts. Warranty doesn't cover transportation costs nor does it cover a product subjected to misuse or accidental damage. Warranty repairs are subjected to inspection and evaluation by us.

**Liability:** We are not liable for damage caused by products that we do not supply or from mishandling in transit, accident, misuse, neglect, lack of care of the product, or service by anyone other than our company.

**Contact Us:** In case of any kind of dissatisfaction, please Contact us immediately and we promise our utmost support and care until you use our product.