

# PROAIM Gimbal Mount for DJI Ronin-S (P-GMBC-01)

## Assembly Manual



### What's In The Box

Please inspect the contents of your shipped package to ensure you have received everything that is listed below.



**Note: No rubber spacers needed for DJI Ronin S.**

All rights reserved.

No part of this document may be reproduced, stored in a retrieval system, or transmitted by any form or by any means, electronic, mechanical, photo-copying, recording, or otherwise, except as may be expressly permitted by the applicable copyright statutes or in writing by the Publisher.

## Gimbal Mount Setup

- Insert Rubber Spacer Set into the inner collar, then tighten it with the help of provided Allen key.



- The outer collar comes with already attached 180 degree rotatable shanks. Attach the outer collar outside the inner collar as shown in the image.



- For your convenience, hold the collar with your hand properly, match the holes, tighten them with the provided Allen bolts using an Allen key.



- Attach the gimbal handle to the collar via two holes present on the collar sides and secure it with the help of knobs.



- Loosen the knobs present on the weight platform, Insert the weight rod into each hole, and re-tighten the knobs to secure it.



- Insert the threaded weights into the holes present on the weight rods. Using the same approach, you can attach the remaining weights to the already attached ones according to your camera balancing.

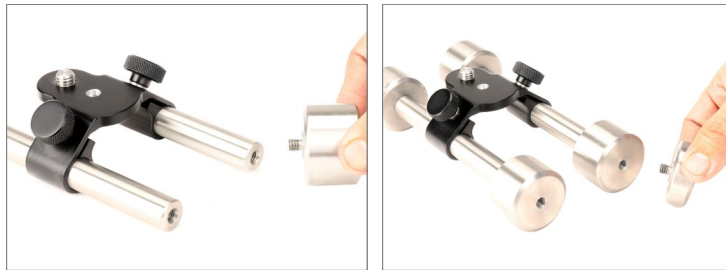

- Loosen the knob & mount the converter adaptor onto the C-Stand.



- Insert the assembled collar into the adapter, after that mount your camera.



- converter adaptor is also compactable with 12mm to 16mm vest diameter hole.



- Insert the weight platform into the Ronin-gimbal base/lower side & tighten it with the help of screw driver.



- You have received 1/4" extra Bolt, according to your Ronin thread compatibility.



**YOUR PROAIM GIMBAL BRACE MOUNT FOR DJI RONIN-S, ZHIYUN CRANE 2 &  
STABILIZER ARM VEST  
ALL DRESSED UP AND READY TO GO!**



**(SHOWN WITH OPTIONAL ACCESSORIES)**

**Warranty:** We offer one year warranty for our products from date of purchase. Within this period of time, we will repair it without charge for labor or parts. Warranty doesn't cover transportation costs nor does it cover a product subjected to misuse or accidental damage. Warranty repairs are subjected to inspection and evaluation by us.

**Liability:** We are not liable for damage caused by products that we do not supply or from mishandling in transit, accident, misuse, neglect, lack of care of the product, or service by anyone other than our company.

**Contact Us:** In case of any kind of dissatisfaction, please Contact us immediately and we promise our utmost support and care until you use our product.