



Compass 360° Photo Booth - Rotating Camera Platform (DL-CMPS-01)



All rights reserved.

No part of this document may be reproduced, stored in a retrieval system, or transmitted by any form or by any means, electronic, mechanical, photo-copying, recording, or otherwise, except as may be expressly permitted by the applicable copyright statutes or in writing by the Publisher.

What's In The Box

Please inspect the contents of your shipped package to ensure you have received everything that is listed below.



Dolly Base leg with top plate



Rod



Rod



Adjustable Angle Rod



Ball Head



17mm Spanner



L-Type Allen Key
(Size: 4mm)



T-Type Allen Keys
(Size: 5mm & 6mm)

INDEX

Sr. No	Particulars	Page No.
1	Rods Mounting	3-4
2	Adjustable angle Rod Mounting	4
3	Ball Head Mounting	5
4	Camera Mounting	5-6
5	Weight Mounting	6
6	Ball Head Rotation	7
7	Adjustable Angle Rod Positioning	7
8	Final Setup	8

Compass 360° Photo Booth Setup

Rods Mounting

- Loosen all Allen bolts of the 360° rod adapter on both sides of the Dolly Base using a 5mm Allen key, then remove them.



- Insert the rod into the 360° rod adapter of the Dolly Base.
- Align the holes and reinsert the Allen bolts.



- Tighten the bolts using a 5mm Allen key to secure the rod firmly.
- The rod is now securely attached to the 360° rod adapter of the Dolly Base.



- Similarly, insert the second rod into the other side of the 360° rod adapter on the Dolly Base.
- Align the holes and reinsert the Allen bolts.

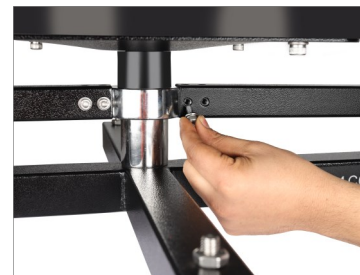

- Now, tighten the bolts with the 5mm Allen key.
- The second rod is now securely attached to the 360° rod adapter of the Dolly Base.

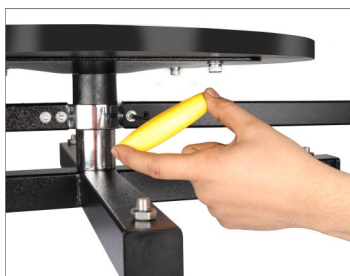

NOTE: Secure the rods with Allen Bolts on both sides.



Adjustable angle Rod Mounting

- Loosen the bottom knob and grub screw using the 4mm Allen Key.
- Insert the adjustable angle rod into the main rod and tighten the knob to secure it.
- Retighten the grub screw with the 4mm Allen key.
- The adjustable rod is now properly attached.



Ball Head Mounting

- Securely attach the Ball Head to the mounting section of the adjustable angle rod. Rotate it until firmly tightened.

Feature: Proaim Compass Turntable Dolly pans 360° effortlessly & smoothly to make the cinematic effect in professional video shoots.

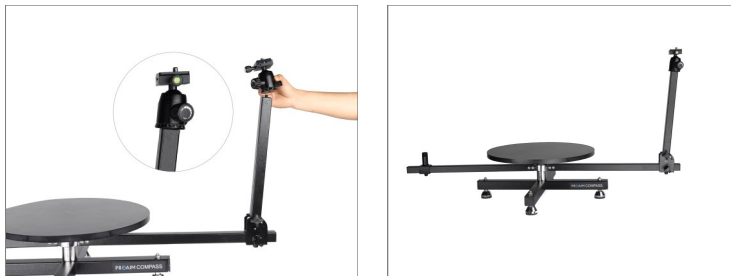

Capture Different Angles

Offers 360° Movement



Camera Mounting

- Loosen the ball head knob and remove the camera plate.

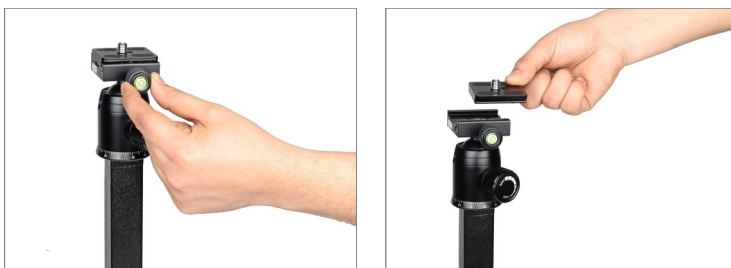

- Loosen the camera bolt of the camera plate with the help of screw driver **(Not Included)** and remove the BS100.



- Now attach the camera plate to the camera **(Not Included)** and tighten it with the screw driver.



- Slide the camera onto the camera plate and tighten it using the knob.



Feature:

Wide Compatibility: The stand interface is compatible with all single-lens reflex, micro-single cameras, phones, and iPads.

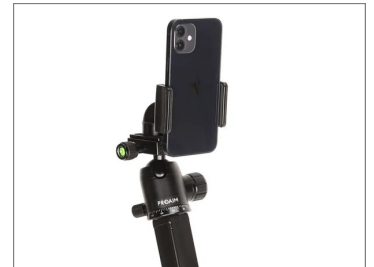

Weight Mounting

- Insert weights onto the rod based on the camera's weight **(Not Included)**.



Ball Head Rotation

- Use the knob to adjust the movement of the center ball.
- The ball head enables smooth circular motion, allowing you to control its movement by loosening or tightening the knob.



Adjustable Angle Rod Positioning

- Loosen both knobs on the adjustable rod to reposition it.
- Once the position is set, re-tighten the both knobs to secure it.

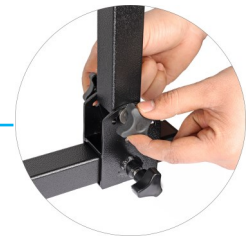

**YOUR PROAIM COMPASS 360° PHOTO BOOTH-ROTATING CAMERA PLATFORM
ALL DRESSED UP AND READY TO GO!**



(SHOWN WITH OPTIONAL ACCESSORIES)

Warranty: We offer one year warranty for our products from date of purchase. Within this period of time, we will repair it without charge for labor or parts. Warranty doesn't cover transportation costs nor does it cover a product subjected to misuse or accidental damage. Warranty repairs are subjected to inspection and evaluation by us.

Liability: We are not liable for damage caused by products that we do not supply or from mishandling in transit, accident, misuse, neglect, lack of care of the product, or service by anyone other than our company.

Contact Us: In case of any kind of dissatisfaction, please Contact us immediately and we promise our utmost support and care until you use our product.