

# PROAIM

18ft Camera Crane Jib, Stand, Sr. Pan-Tilt | Gimbal Compatible (P-18-JS-SRPP)



---

All rights reserved.

No part of this document may be reproduced, stored in a retrieval system, or transmitted by any form or by any means, electronic, mechanical, photo-copying, recording, or otherwise, except as may be expressly permitted by the applicable copyright statutes or in writing by the Publisher.

## What's In The Box

Please inspect the contents of your shipped package to ensure you have received everything that is listed below.

### Jib Section Accessories:



1st Section



2nd Section



3rd Section



4th Section



5th Section



LCD Mounting Arm



5 x Velcro



Central Fork



Tool Pouch



2 x Weight Closers



2 x Jib Section Bags



2 x Knobs



Bush



Weight Rod



Plastic Screw Driver



Jib Stand



Bag Packing

# Sr. Pan and Tilt Head with Accessories (PT-SR):



Sr. Pan-Tilt Head



AC Adapter



Cable and XLR Cable



Joystick Controller with cap



Universal Adapter



1/4" MS Check Nut



4 x Fasteners



2 x Fuse



2 x L-Type Allen Keys (3/16" & 2mm)



Bag Packing

# INDEX

Sr. No	Particulars	Page No.
1	Jib Stand Assembly	5
2	Jib Stand Height Adjustment	5
3	Central Fork Mounting	7
4	4th Section Mounting on Central Fork	7
5	5th Section Mounting	8
6	Adjusting the Central Pool Adapter	9
7	Bush Mounting	10
8	3rd Section Mounting	10-11
9	1st Section & 2nd Section Mounting	12
10	Wire Tensioner Assembly	12
11	Weight Rod Mounting	13
12	LCD Mount Arm Mounting	14-15
13	LCD Mounting	15
14	Joystick Controller Mounting	15
15	Sr. Pan-Tilt Mounting	15-16
16	Camera Mounting	16-17
17	Cable & XLR Cable Mounting	17-18
18	AC Adapter & Universal Adapter Assembly	18
19	Parts Of Joystick Controller	19
20	Final Setup	21

## Camera Crane Jib, Stand, Sr. Pan-Tilt Setup

### Jib Stand Assembly

- Loosen the knob on the jib stand and adjust the legs to your desired position.



- Once the legs are in place, tighten the knob to secure it.



### Jib Stand Height Adjustment

- Loosen the knob to adjust the stand height.
- Raise the stand to the desired height.



- Once the stand reaches the desired height, secure it by locking the pin in place.
- Tighten the knob again to secure the stand.



- The stand's height is now securely adjusted.



## Jib Stand Features:



## Central Fork Mounting

- Mount the central fork on the Jib stand.
- Insert the knob, ensuring the holes are aligned.
- Tighten the knob.
- The central fork is now securely mounted on the Jib Stand.



## 4th Section Mounting on Central Fork

- Use a spanner to loosen the dome nut on the central fork and remove the black washers, shank, and dome nut.
- Insert the end of the 4th section into the central fork.
- Align the holes of the section with the center post, then insert the shank and reinsert the black washer and dome nut.
- Tighten the dome nut on both sides using a 13mm spanner.
- Secure the jib section with a pin, as shown in the image.
- The jib section is now securely attached to the middle section.

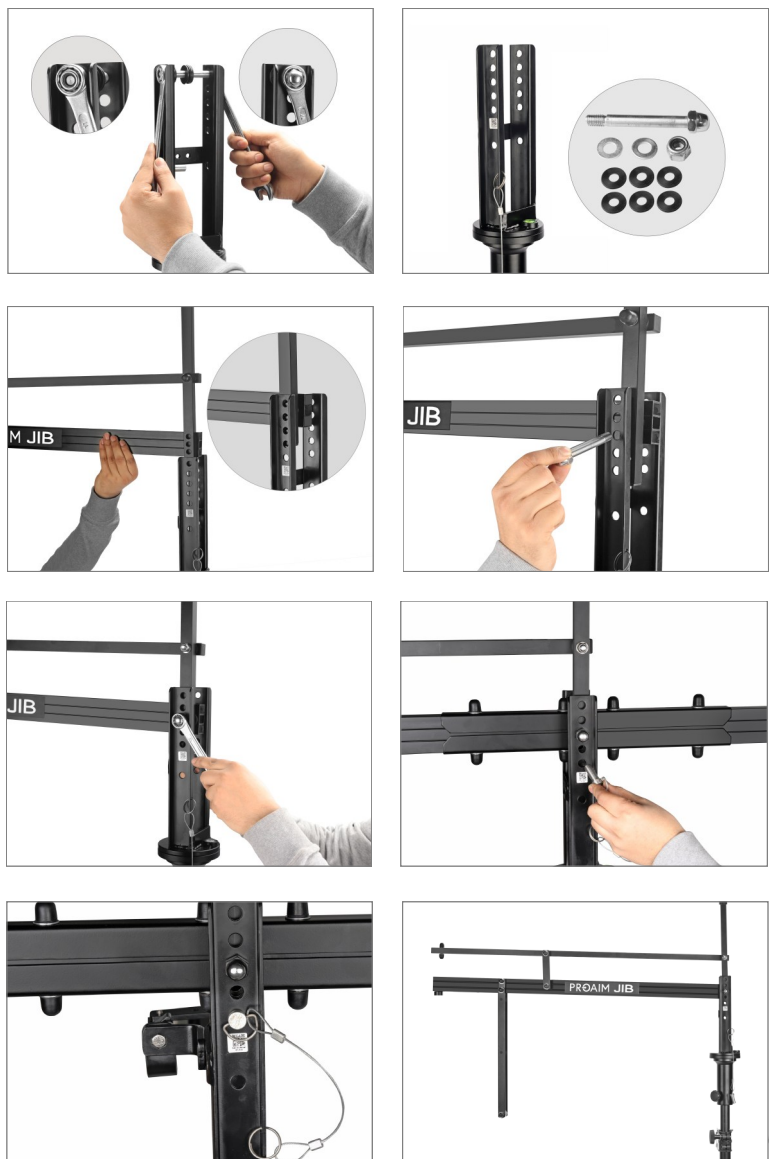

## 5th Section Mounting

- Remove the bolts from both the top and bottom sides of the 5th section of the jib, as shown in the image.

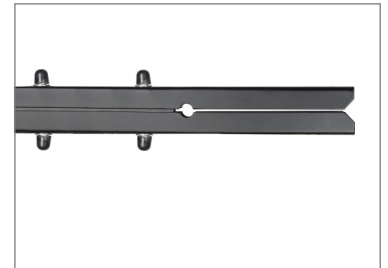
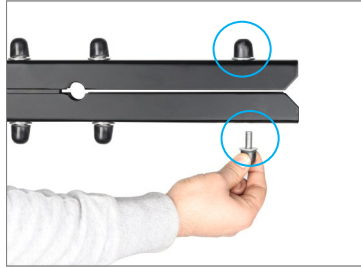

- Repeat the same for the remaining bolts of the 5th section.

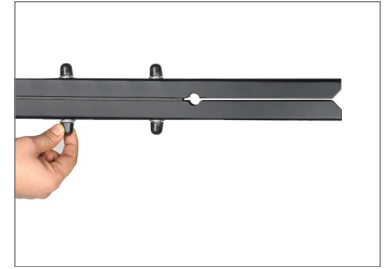
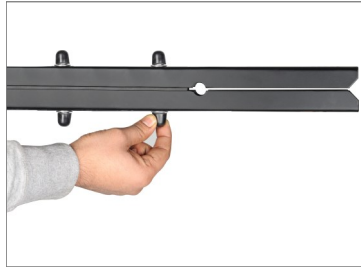

- Insert the 5th section into the end of the 4th section.



- Re-insert the bolts on both the top and bottom sides and tighten them securely.



- Tighten the remaining bolts .
- The 5th section is now securely attached to the 4th section.

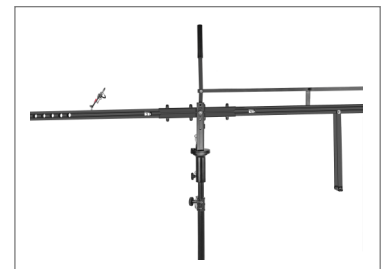

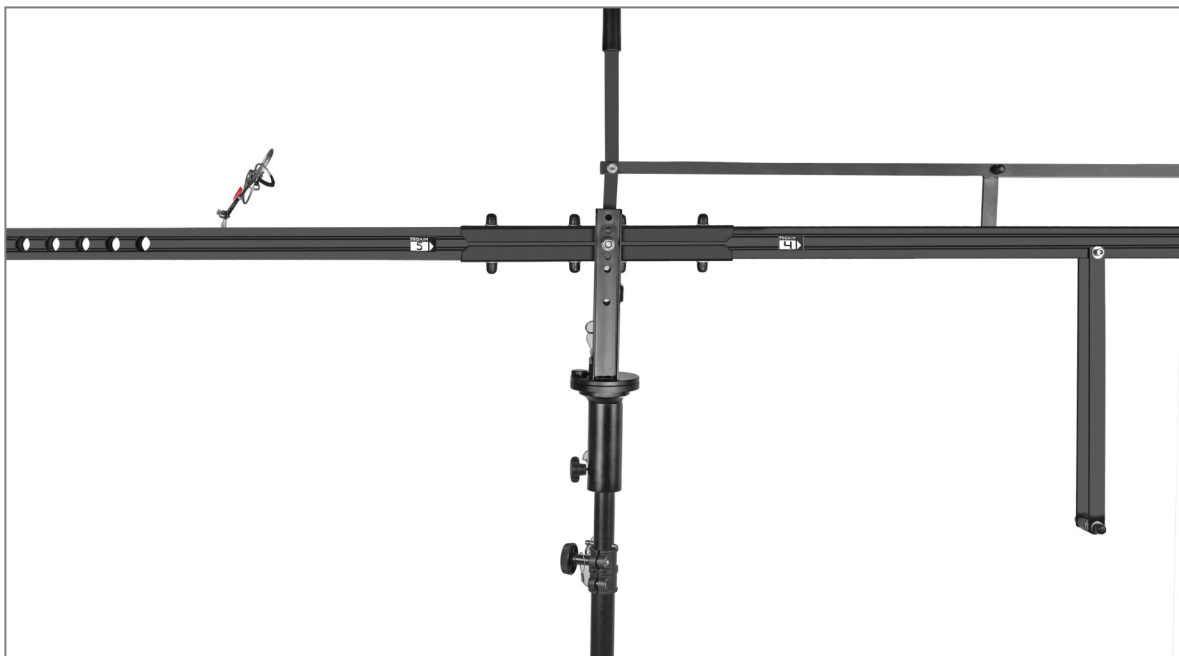

## Adjusting the Central Pool Adapter

- Remove the bolt from the 4th section near the central pool adapter.
- Rotate the central pool adapter to adjust its position.



- Once the position is set, insert the bolt to secure the central pool adapter, as shown in the image.
- Tighten the bolt using a 13mm spanner and a 6mm Allen key.

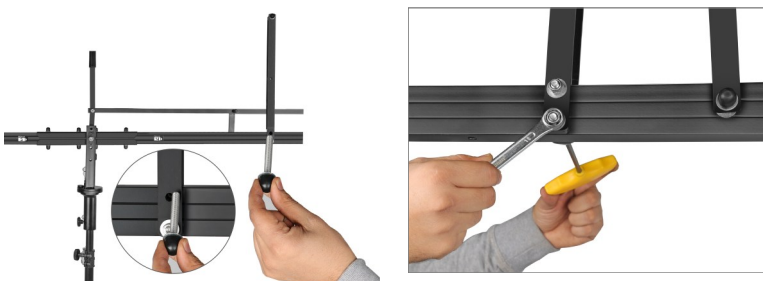

- After tightening the bolts, reattach the cap.

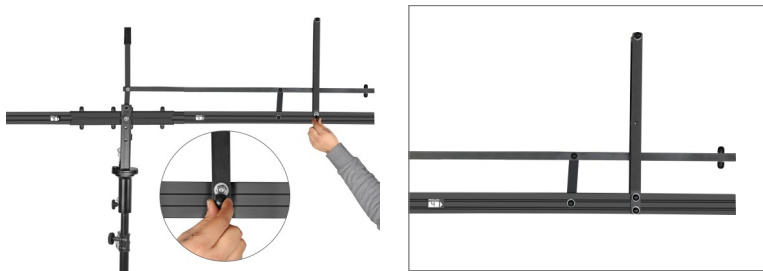

## Bush Mounting

- Remove the bolt, washer, nut, and rubber cap from the bush.
- Insert the bush into the central pool adapter, then insert the bolt with the rubber cap and washer.
- Attach the nut with the rubber cap on the other side.
- Tighten the bolt using a 6mm Allen key and a 13mm spanner.

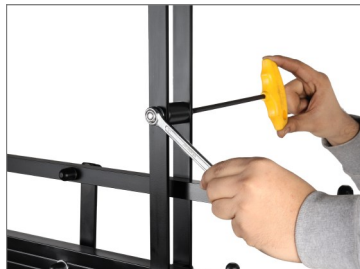

## 3rd Section Mounting

- Remove the bolts from the 4th Section of the jib.
- Loosen the nut and remove the long bolt from the front end of the 3rd Section of the jib.

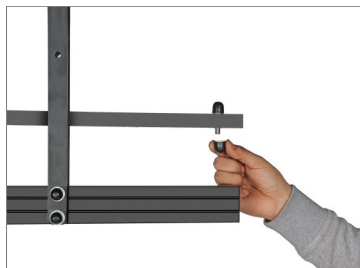

- Remove caps from all the bolts of the 3rd Section.
- Loosen the remaining bolts using a 6mm Allen key and a 13mm spanner.

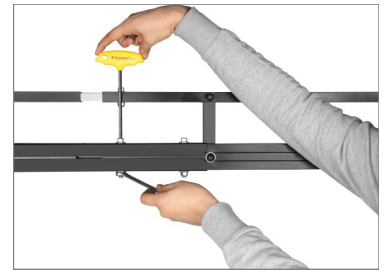

- Insert the 3rd Section into the front end of the 4th Section.

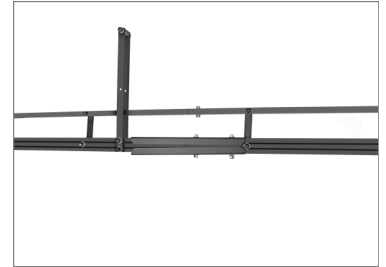
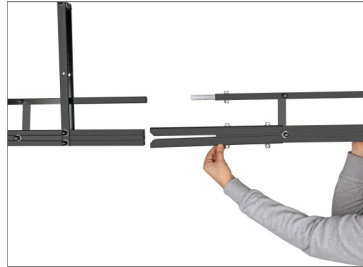

- Insert the long bolt and nut, ensuring the holes are aligned.



- Insert the bolt and nut into the top section of the jib, ensuring the holes are aligned.



## 5th Section, 4th Section & 3rd Section

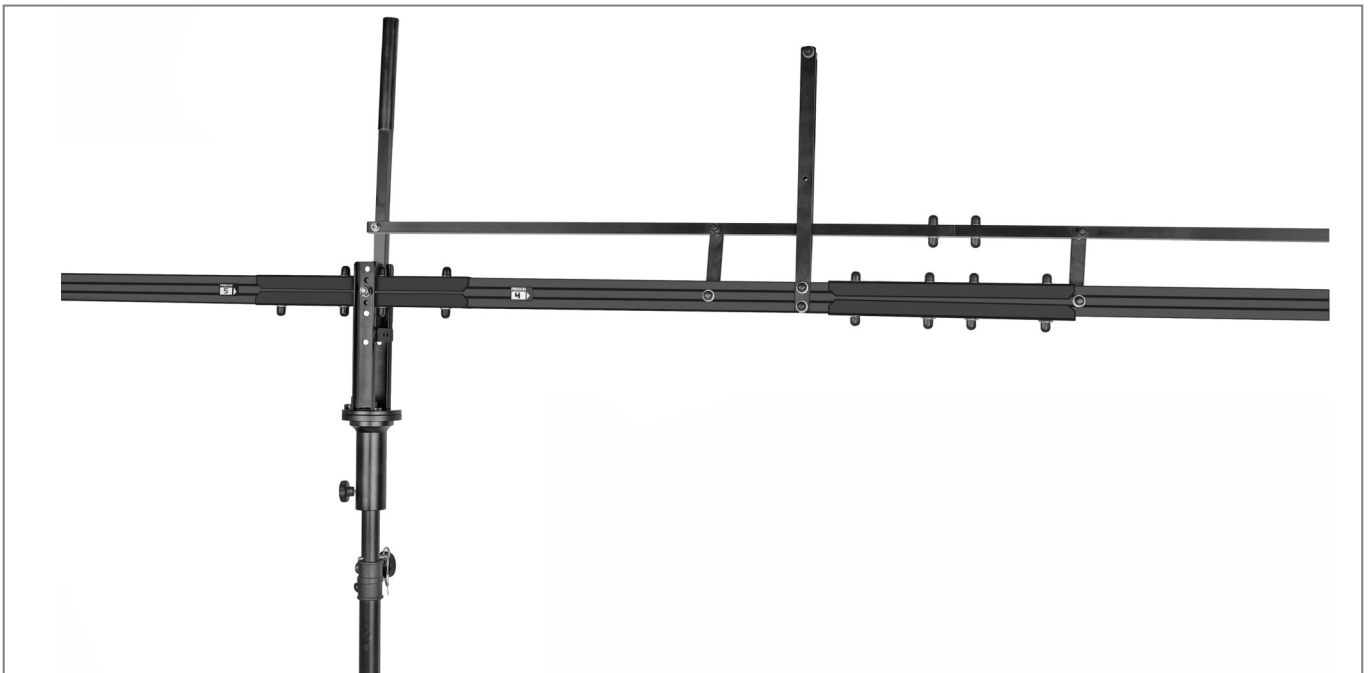

## 1st Section and 2nd Section Mounting

- Repeat the same steps to insert the 2nd section into the 3rd section, and the 1st section into the 2nd section.
- The Jib sections are now securely attached.

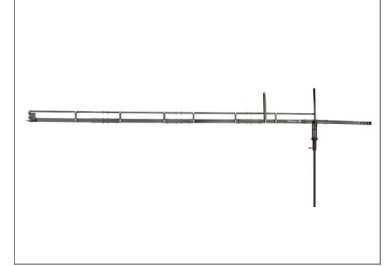

## Wire Tensioner Assembly

- Connect the wire tensioner (attached to the 1st section) to the wire (attached to the 5th section).
- Mount the wire onto the central pool adapter.
- Rotate the mid-section handle to tighten the cable, applying the required amount of tension to the system.

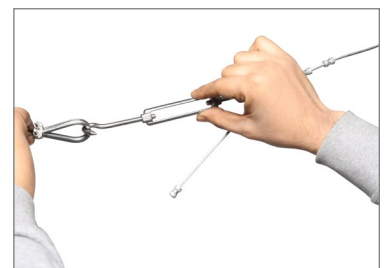
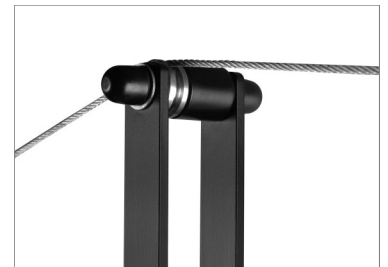
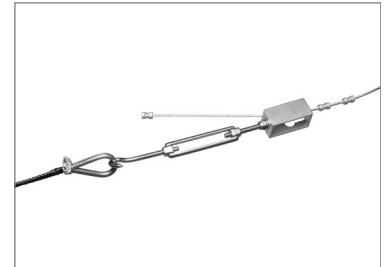

## Stability in Any Environment

Wire System adds Rigidity  
& Reduces Vibration during Movement



## Weight Rod Mounting

- Insert the weight rod into the 5th Section and add the weights (Not included) onto it.

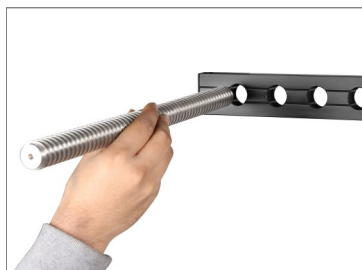

- Secure the weights by attaching the weight closer.
- Add weights to the other side of the weight rod using the same process, based on your preference.

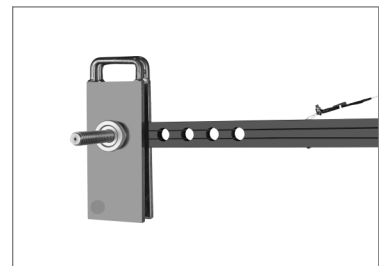

**NOTE:** The arm length can be adjusted to 18, 14, or 12 feet by easily removing a jib section, providing versatility for different shooting scenarios.



## LCD Mount Arm Mounting

- Loosen the knob on the LCD mounting arm.
- Attach the mounting arm to the central post.



- Insert the washer and knob.
- Tighten the knob securely to hold it in place.



- The LCD mounting arm is now securely attached.

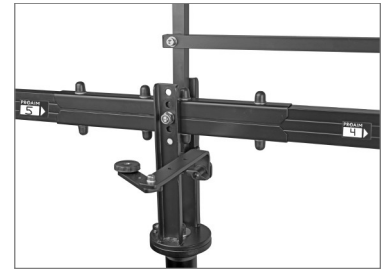

## LCD Mounting

- Mount the LCD (Not included) and tighten the knob securely.
- The LCD is now securely mounted.



- Install the camera bolt (Not Included) into the LCD Monitor Arm.



- Attach the monitor to the LCD Monitor Arm and tighten the camera bolt using a plastic screwdriver.



## Joystick Controller Mounting

- Loosen both knobs on the joystick controller.
- Slide the joystick controller onto the weight rod and secure it in place.

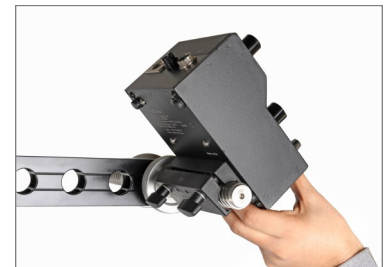

- Once in position, re-tighten both knobs.
- The Joystick controller is now securely attached.

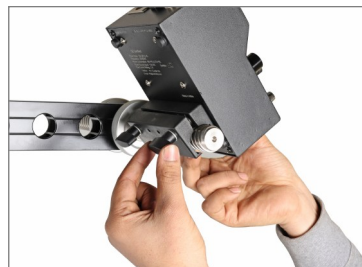

## Sr. Pan-Tilt Head Mounting

- Attach the Sr. Pan-Tilt Head to the head platform and insert the bolt.
- Insert the fastener and tighten it securely.
- The Sr. Pan-Tilt Head is now firmly attached to the head platform.



## Camera Mounting

- Mount the camera (**Not included**) onto the camera plate and insert the 1/4" camera mounting screw.



- Use the 3/16" L-type Allen key to tighten the screw.



- Adjust the camera plate position by loosening or tightening the bolt using a 3/16" Allen key.

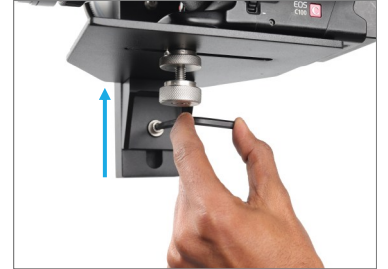

- The camera is now securely mounted.

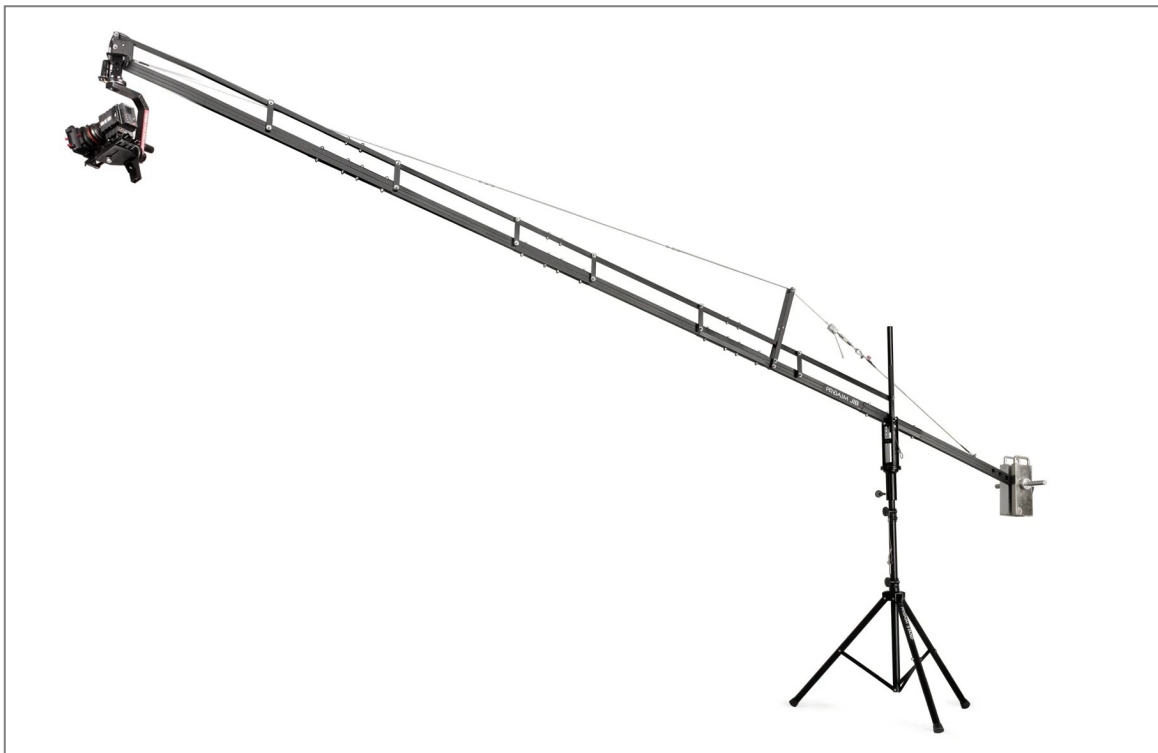

## Cable & XLR Cable Assembly

- Connect the female end of the pan-tilt cable to the male end of the XLR cable.



- Connect the female end of the cable to the joystick controller.



- Connect the female end of the AC adapter to the joystick controller.



## AC Adapter & Universal Adapter Assembly

**CAUTION:** Avoid using an unregulated power supply.

- Ensure that the regulated power supply provides less than 24 volts.
- Using a power supply of 24 volts or higher is not recommended, as it may cause permanent damage.

- Connect one end of the power cable to the remote controller.



- Connect the other end of the power cable to the universal adapter.



- Speed controller adjusts the pan/tilt speed based on the shot requirements.
- Damping control prevents abrupt stops, allowing for smooth motion and seamless endings.
- The pan and tilt direction can be reversed as needed.



# Parts of Joystick Controller

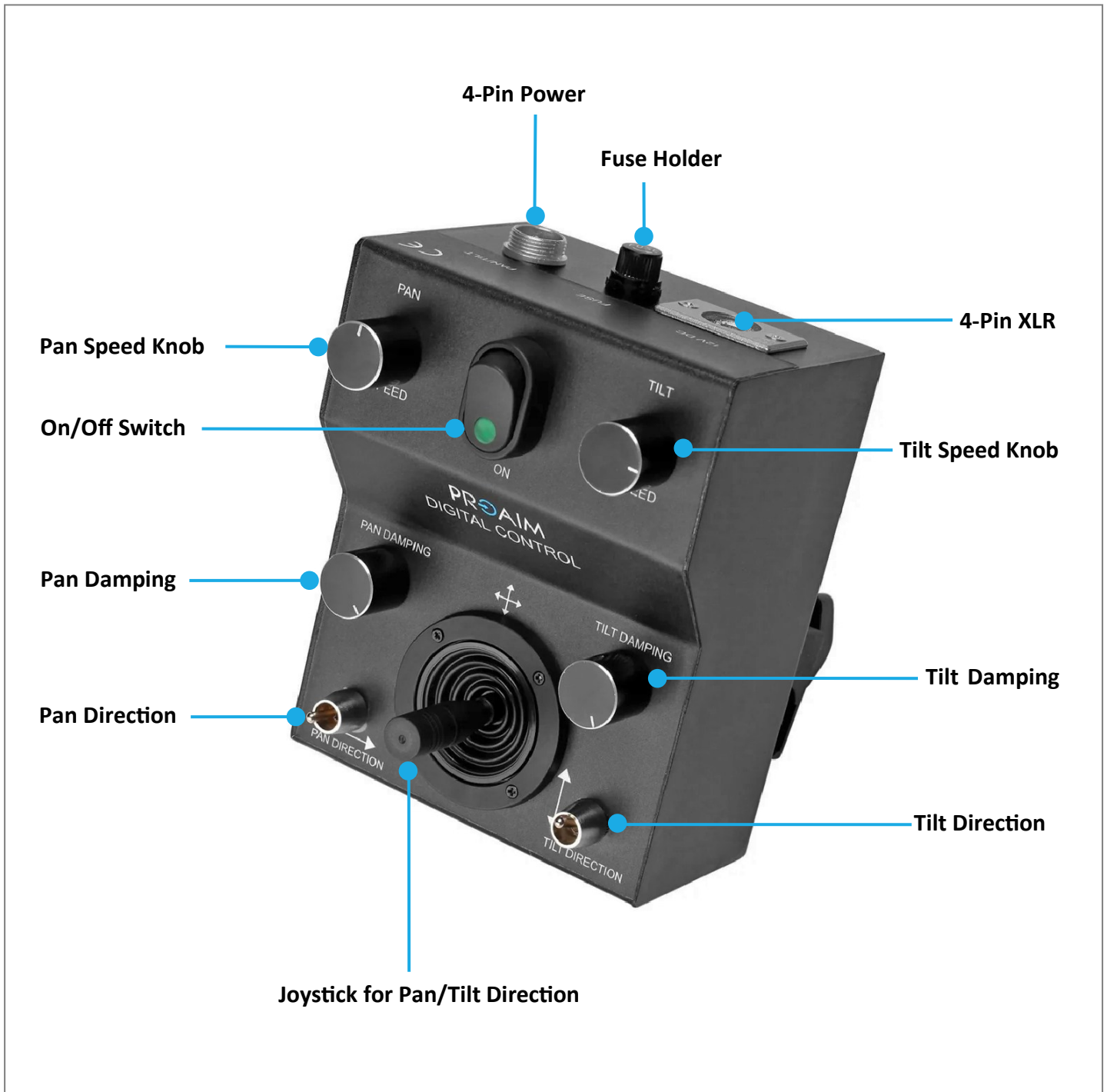

- Power on the joystick controller.



- Adjust the pan and tilt speed as per your requirements.



- Adjust the pan and tilt damping to suit your needs.



**NOTE:** The jib is compatible with 3-axis gimbals, pan-tilt heads, and fluid heads. Its universal front mounting allows for easy attachment of pan-tilt heads and 3-axis gimbal stabilizers. The camera mount tilt control provides both auto tilt and manual tilt modes, operated via a control handle.

## Professional & Versatile Design

### Adapts 3-Axis Gimbals, Pan Tilts & Fluid Heads



**YOUR PROAIM 18FT CAMERA CRANE JIB, STAND,SR.PAN-TILT  
ALL DRESSED UP AND READY TO GO!**



**(SHOWN WITH OPTIONAL ACCESSORIES)**

**Warranty:** We offer one year warranty for our products from date of purchase. Within this period of time, we will repair it without charge for labor or parts. Warranty doesn't cover transportation costs nor does it cover a product subjected to misuse or accidental damage. Warranty repairs are subjected to inspection and evaluation by us.

**Liability:** We are not liable for damage caused by products that we do not supply or from mishandling in transit, accident, misuse, neglect, lack of care of the product, or service by anyone other than our company.

**Contact Us:** In case of any kind of dissatisfaction, please Contact us immediately and we promise our utmost support and care until you use our product.